

PROJECT PLANT MATERIAL SCHEDULE:

KEY SYMBOL	BOTANICAL NAME	COMMON NAME	SIZE	QTY	REMARKS
AR	Acer rubrum	Red Maple Tree	1 1/2" cal	6	B&B
PS	Prunus serotina	Black Cherry Tree	1 1/2" cal	6	B&B
BN	Betula nigra	River Birch Tree	1 1/2" cal	6	B&B
SC	Sambucus canadensis	Elderberry Shrub	12"-18"	14	#5 Cont.
CA	Cornus amomium	Silky Dogwood	12"-18"	8	#5 Cont.
GD	Gymnocladus dioica	Kentucky Coffee Tree	1 1/2" cal	3	B&B
IV	Ilex verticillata 'Winter Red'	Winter Red Winterberry Shrub	12"-18"	21	#5 Cont. male/female
MP	Myrica pennsylvanica	Bayberry	12"-18"	14	#5 Cont.
CO	Cephaanthus occidentalis	Butterbush	12"-18"	8	#5 Cont.

Wet Pond Aquatic Bench (AB MIX) Area Species

PC	Pontederia cordata	Pickeralweed	2" PLUG	99	2'-0" O.C.
SC	Scheuchzeria palustris	Woolgrass	2" PLUG	88	2'-0" O.C.
SV	Scirpus validus	Soft-stem Bulrush	2" PLUG	88	2'-0" O.C.
IVS	Iris virginica var. shrevei	Virginia Iris	2" PLUG	99	2'-0" O.C.

PROJECT PLANT MATERIAL LEGEND:

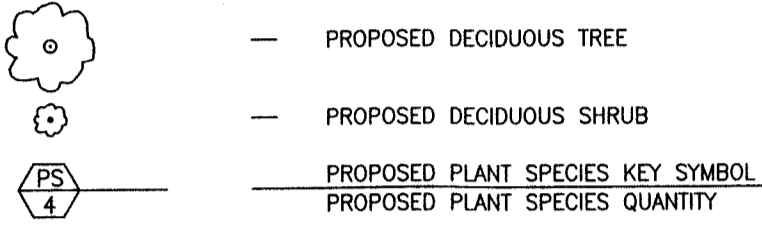

PLANTING NOTES:

- THE CONTRACTOR SHALL SUPPLY ALL PLANT MATERIALS SUFFICIENT TO COMPLETE THE PLANTING QUANTITIES SHOWN ON THIS DRAWING.
 - ALL MATERIAL SHALL CONFORM TO THE GUIDELINES ESTABLISHED BY THE CURRENT AMERICAN STANDARD FOR NURSERY STOCK, PUBLISHED BY THE AMERICAN ASSOCIATION OF NURSERYMEN OR EQUIVALENT.
 - ALL PLANTS SHALL BE BALLED AND WRAPPED OR CONTAINER GROWN AS SPECIFIED. NO CONTAINER GROWN STOCK WILL BE ACCEPTED IF IT IS ROOT BOUND. ALL ROOT WRAPPING MATERIAL MADE OF SYNTHETICS OR PLASTICS SHALL BE REMOVED AT TIME OF PLANTING.
 - ALL PLANTS SHALL BE SPRAYED WITH AN ANTIDESICCANT AT THE BEGINNING OF THEIR FIRST WINTER (IF OWNER REQUESTS).
 - ALL PLANTS SHALL BE WATERED THOROUGHLY TWICE DURING THE FIRST 24-HOUR PERIOD AFTER PLANTING. ALL PLANTS SHALL THEN BE WATERED WEEKLY OR MORE OFTEN, IF NECESSARY, DURING THE FIRST GROWING SEASON (IF OWNER REQUESTS).
 - PROTECT EXISTING TREES WHICH ARE TO BE PRESERVED FROM ALL POSSIBLE TYPES OF ROOT, TRUNK, AND LIMB DAMAGE.
 - ALL NEW PLANTING MATERIAL SHALL HAVE A TWO YEAR REPLACEMENT GUARANTEE STARTING FROM FINAL ACCEPTANCE BY THE LANDSCAPE ARCHITECT.
- PERMANENT GROUND COVER SEED MIXES:**
- (VS/B) FOR VEGETATED SWALE AND BASIN SIDELAPSES, SEED MIX AS FOLLOWS:
PERENNIAL RYE GRASS: 0.68 LBS. PER 1,000 S.F.
TALL FESCUE: 0.45 LBS. PER 1,000 S.F.
REDTOP: 0.05 LBS. PER 1,000 S.F.
 - (PSL) FOR PERMANENT LAWNS AROUND BUILDING TO BE MOWED AS FOLLOWS:
65% KENTUCKY BLUEGRASS @ 2.5 LBS. PER 1,000 S.F.
20% PERENNIAL RYEGRASS @ 0.6 LBS. PER 1,000 S.F.
15% FINE FESCUE @ 0.5 LBS. PER 1,000 S.F.
 - (PSR) FOR PERMANENT SEEDING FOR ROUGH AREAS TO BE UNMOWED AS FOLLOWS:
COMMON WHITE CLOVER @ 0.20 LBS. PER 1,000 S.F.
TALL FESCUE @ 0.45 LBS. PER 1,000 S.F.
PERENNIAL RYE GRASS @ 0.10 LBS. PER 1,000 S.F.
 - (TR) FOR TEMPORARY GROUND SEEDING FOR EROSION CONTROL AS FOLLOWS:
PERENNIAL RYE GRASS @ 0.7 LBS. PER 1,000 S.F.

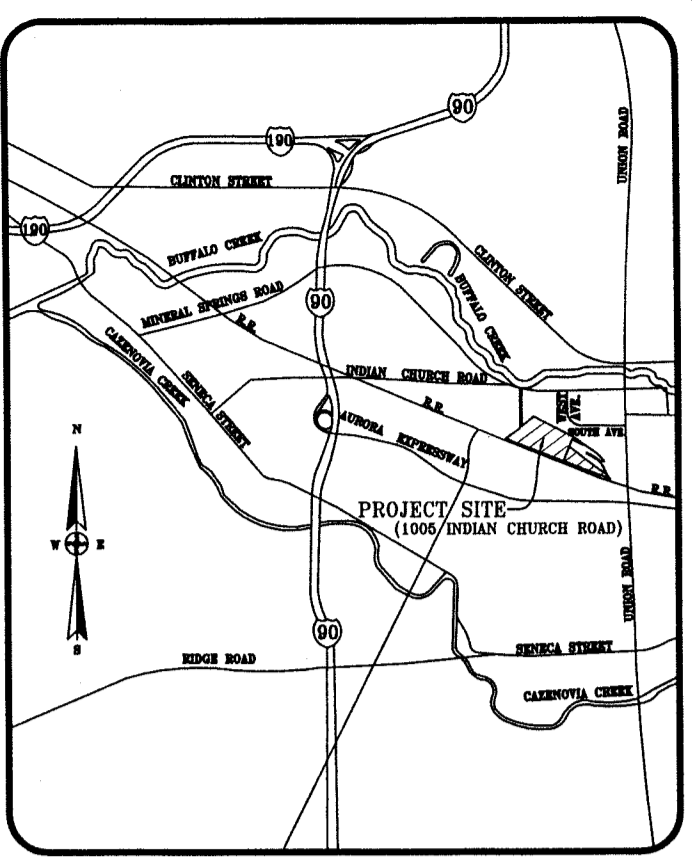

REVISIONS	DESCRIPTION	DATE

PROJECT TITLE: PROPOSED RAIL CAR MANUFACTURING FACILITY
 CLIENT: ERS INDUSTRIES, INC. (1-716-674-5650)
 1005 INDIAN CHURCH ROAD
 WEST SENECA, NEW YORK 14224
 DRAWING TITLE: LAYOUT, LIGHTING & LANDSCAPING PLAN

APEX CONSULTING
 SURVEY & ENGINEERING SERVICES, P.C.
 SURVEYING • ENGINEERING • LANDSCAPE ARCHITECTURE
 102 EAST AVENUE, LOCKPORT, NEW YORK 14094
 Phone: (716) 439-0188 FAX: (716) 439-0189

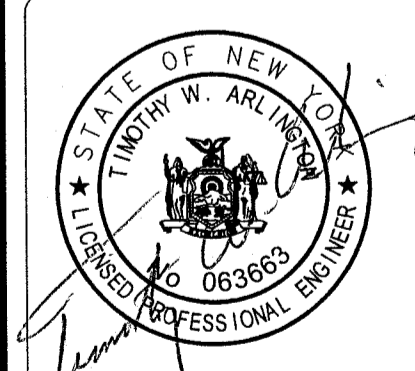

DATE: 03/18
 SCALE: 1"=50'
 PROJECT NO.: 17-144
 DRAWN BY: KSB
 CHECKED BY: TWA

- GENERAL NOTES:**
- LOCATION OF EXISTING UTILITIES ARE APPROXIMATE. CONTRACTOR TO VERIFY LOCATION (HORIZONTAL & VERTICAL) PRIOR TO CONSTRUCTION.
 - VERIFY ALL EXISTING CONDITIONS (I.E. AS-BUILT LOCATIONS, ELEVATIONS & DIMENSIONS) PRIOR TO BID PREPARATION AND CONSTRUCTION.
 - CONTRACTOR IS TO OBTAIN PERMISSION TO ACCESS UTILITIES WITHIN RIGHT-OF-WAY AND/OR UNDER THE AUTHORITY OF OTHERS.
 - CONTRACTOR SHALL TAKE ALL REASONABLE MEASURES TO PROTECT EXISTING TREES WHICH ARE TO BE PRESERVED FROM ALL TYPES OF ROOT, TRUNK AND LIMB DAMAGE; INCLUDING BUT NOT LIMITED TO, RETAINING WALLS AND CONSTRUCTION FENCE WHICH PREVENT FILLING ON TOP, OR SOIL COMPACTION OVER ROOTS.
 - ALL CONSTRUCTION SHALL BE IN ACCORDANCE WITH LOCAL CONSTRUCTION SPECIFICATIONS WHERE APPLICABLE AND/OR SUBJECT TO THE LATEST REVISION BY THE TOWN ENGINEER.
 - CONTRACTOR SHALL REPAIR ALL SIDEWALKS, PAVEMENTS AND LAWN AREAS DISTURBED BY SITE WORK.
- CONSTRUCTION NOTES:**
- THE CONTRACTOR SHALL VERIFY ALL DIMENSIONS IN FIELD PRIOR TO CONSTRUCTION. ANY DISCREPANCIES SHALL BE BROUGHT TO THE ENGINEER'S ATTENTION PRIOR TO COMMENCING.
 - THE CONTRACTOR SHALL BE RESPONSIBLE FOR THE PROTECTION OF WORKERS AND OTHER PERSONS BY ANY MEASURES DURING CONSTRUCTION.
 - THE CONTRACTOR SHALL KEEP THE JOB SITE CLEAN, ORDERLY, AND FREE OF DEBRIS ON A DAILY BASIS. FINAL CLEANUP SHALL BE TO THE OWNERS SATISFACTION.
 - REFER TO DWG. NO. DT-1 AND DT-2 FOR SITE CONSTRUCTION DETAILS.

PROJECT SITE DATA:
 TAX MAP ID #: 134.07-3-18.211
 TOTAL PARCEL SIZE: 45± AC
 PROJECT AREA: 9.5 ACRES
 CURRENT ZONING: MANUFACTURING (M-2)
 EXISTING USE: RAILCAR SERVICE AND REPAIR
 PROPOSED USE: RAILCAR MANUFACTURING
 MINIMUM FRONT YARD SETBACK REQ: 25 FEET
 MINIMUM SIDE YARD SETBACK REQ: 10 FEET
 MINIMUM REAR YARD SETBACK REQ: 10 FEET
 MAXIMUM BUILDING HEIGHT ALLOWED: 40 FEET
 PARKING REQ. FOR MANUFACTURING: 1 SPACE PER 1,000 S.F.
 PROPOSED NEW BUILDING S.F. = 94,000 S.F.
 PARKING REQUIRED = 94 SPACES
 NEW PARKING PROVIDED = 107 SPACES
 PARKING SPACE SIZE REQUIRED = 9'X18'

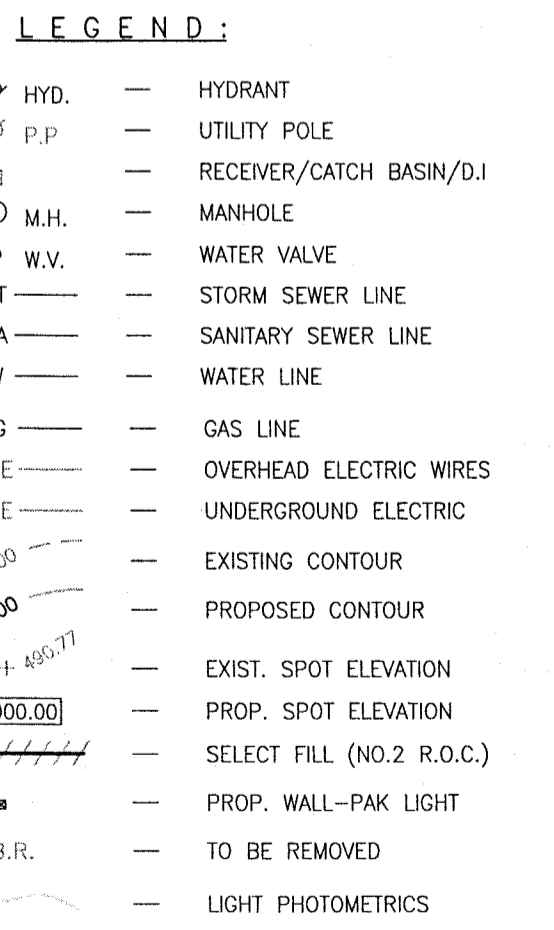

SITE LAYOUT PLAN
 SCALE: 1"=50'

NOTE: THESE PLANS DO NOT ASSURE THE PRESENCE OR LOCATION OF UTILITIES. THE CONTRACTOR SHALL NOTIFY "DIG SAFELY-NEW YORK" TOLL FREE AT 1-800-962-7962 TWO (2) FULL WORKING DAYS BEFORE THE START OF CONSTRUCTION, NOT COUNTING THE DAY OF YOUR CALL.