

INDIAN CHURCH ROAD
(FORMERLY WINCHESTER AVENUE)
(66' WIDE)

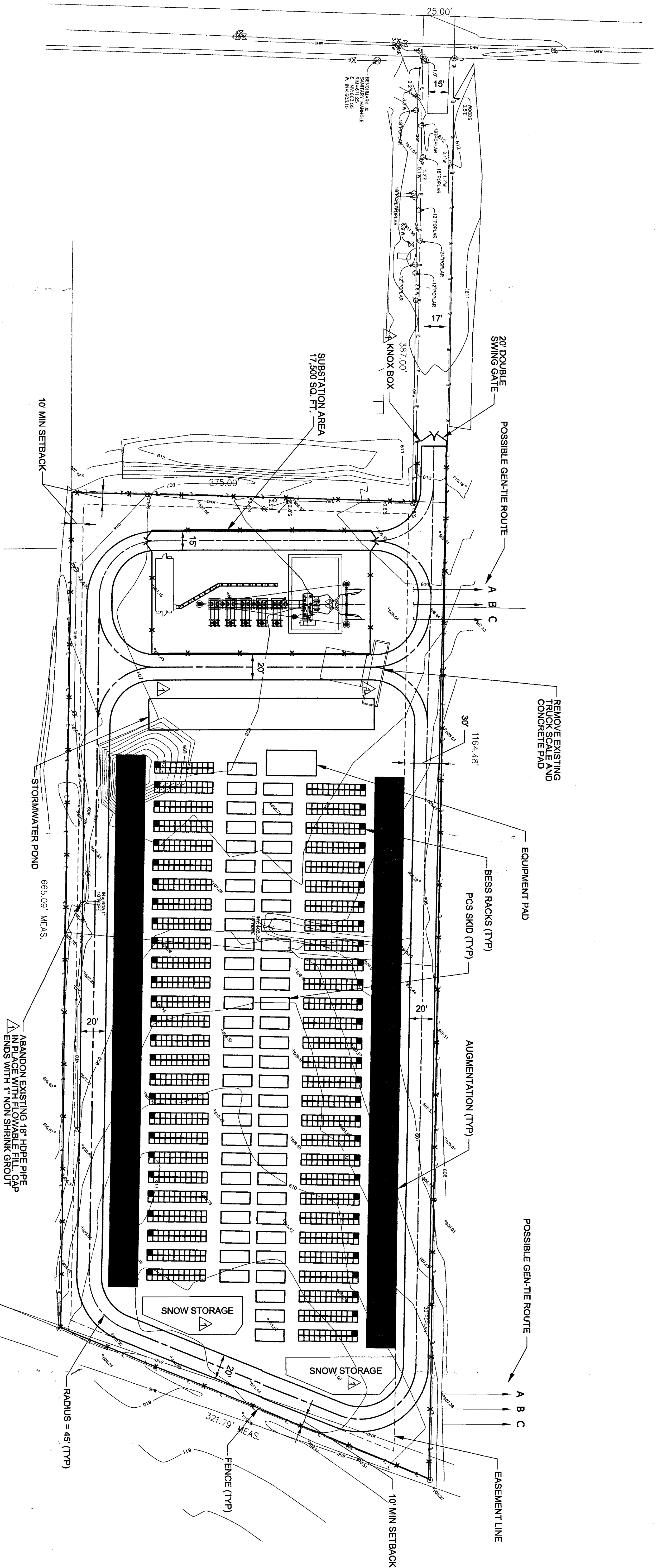

GENERAL SITE PLAN

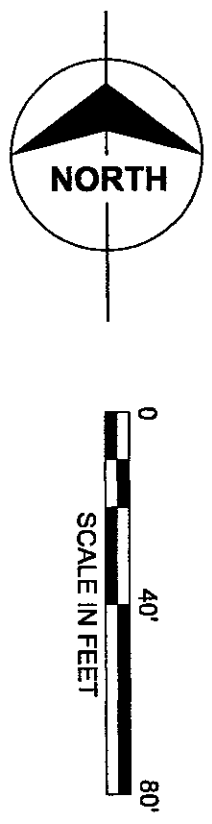

SITE DATA
ZONING DISTRICT: M-1 & M-2
PROPERTY ADDRESS: 799 INDIAN CHURCH ROAD
SECTIONAL LOT: 194.06-2-28
PARCEL ACREAGE: 5.16 ACRES
LIMITS OF DISTURBANCE ACREAGE: 5.16 ACRES
LAND OWNER: NOVA SITE COMPANY, LLC
MAILING ADDRESS: 6 LENA COURT, WEST SENECA, NY 14224
APPLICANT: LEVY GRID, LLC
MAILING ADDRESS: 1495 CANYON BOULEVARD, SUITE 218,
BOULDER, CO 80302

ISSUED FOR PERMITTING - NOT FOR CONSTRUCTION

LEVY GRID GENERAL SITE PLAN
125219
drawing **SKC001** of 1 sheets
rev 1
Sep 22 2020 9:04 AM

no.	date	by	ckd	description
0	07/29/20	ERA	-	ISSUED FOR REVIEW
1	09/22/20	ERA	-	ISSUED FOR PERMITTING

no.	date	by	ckd	description

BURNS & MCDONNELL
9400 WARD PARKWAY
KANSAS CITY, MO 64114
816-333-9400
Burns & McDonnell Consultants, P.C.
FLM LICENSE NO. 03119399
designed by E. ASNICAR detailed by E. ASNICAR

LEVY GRID
WEST SENECA, NEW YORK
project 125219
contract
drawing SKC001
sheet 1 of 1 sheets