

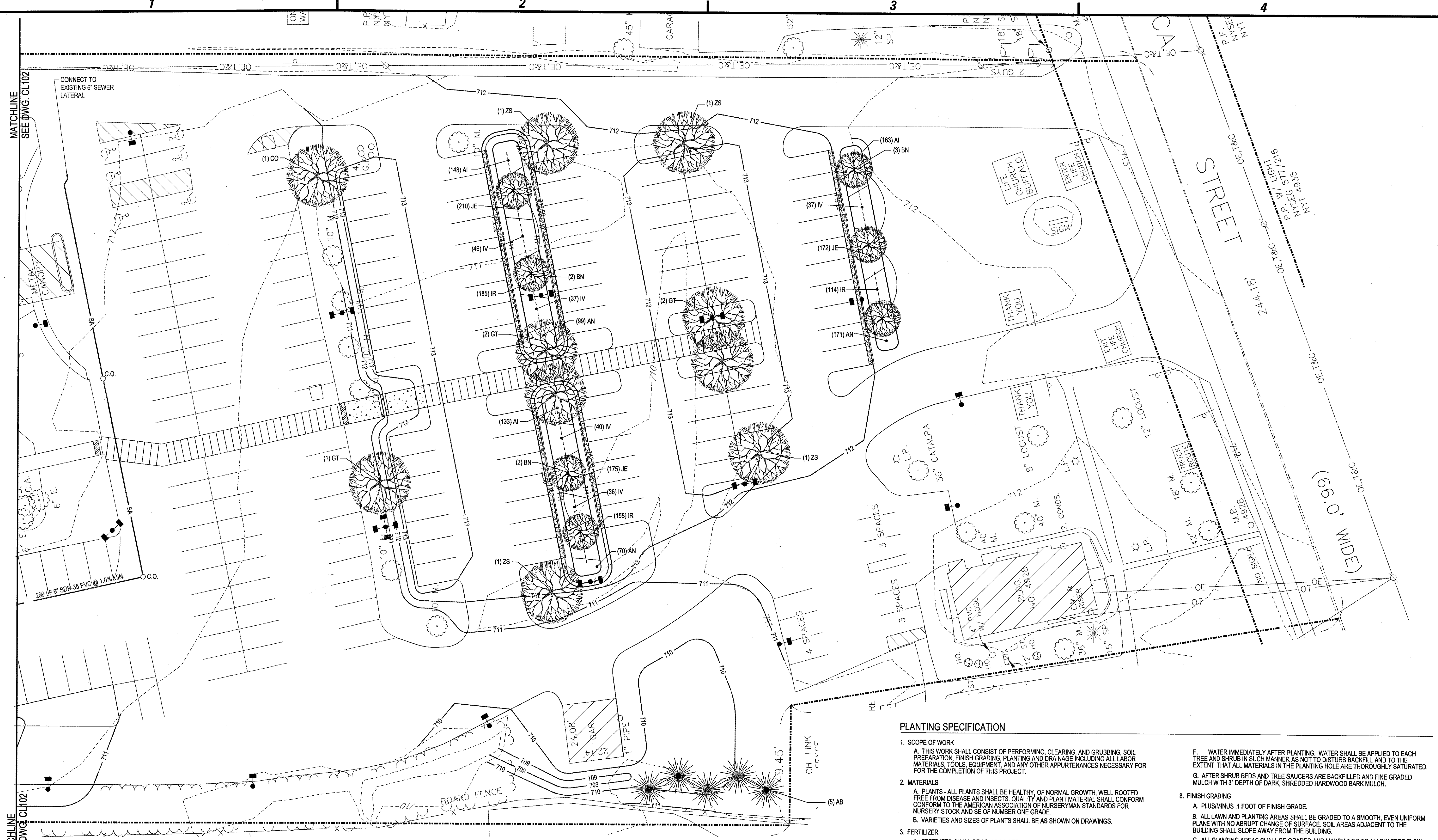

C&S Engineers, Inc.
141 Elm St. Suite 100
Buffalo, New York 14203
Phone: 716-847-1630
Fax: 716-847-1454
www.cscos.com



LIFE CHURCH -
NEW GATHERING & WORSHIP SPACE
4928 SENECA STREET
WEST SENECA, NEW YORK



PLANTING SPECIFICATION

- SCOPE OF WORK
 - A. THIS WORK SHALL CONSIST OF PERFORMING, CLEARING, AND GRUBBING, SOIL PREPARATION, FINISH GRADING, PLANTING AND DRAINAGE INCLUDING ALL LABOR MATERIALS, TOOLS, EQUIPMENT, AND ANY OTHER APPURTENANCES NECESSARY FOR THE COMPLETION OF THIS PROJECT.
- MATERIALS
 - A. PLANTS - ALL PLANTS SHALL BE HEALTHY, OF NORMAL GROWTH, WELL ROOTED FREE FROM DISEASE AND INSECTS. QUALITY AND PLANT MATERIAL SHALL CONFORM TO THE AMERICAN ASSOCIATION OF NURSERYMAN STANDARDS FOR NURSERY STOCK AND BE OF NUMBER ONE GRADE.
 - B. VARIETIES AND SIZES OF PLANTS SHALL BE AS SHOWN ON DRAWINGS.
- FERTILIZER
 - A. FERTILIZER SHALL BE MILORGANITE (6-2-0)
- GENERAL WORK PROCEDURES
 - A. LANDSCAPE WORK SHALL BE ACCORDING TO THE WORKMANLIKE STANDARDS ESTABLISHED FOR LANDSCAPE CONSTRUCTION AND PLANTING.
- WEEDING
 - A. BEFORE AND DURING PRELIMINARY GRADING AND FINISH GRADING, ALL WEEDS AND GRASSES SHALL BE DUG OUT BY THE ROOTS AND DISPOSED OF AT THE CONTRACTOR'S EXPENSE.
- SOIL CONDITIONING
 - A. CULTIVATE ALL AREAS TO BE PLANTED TO A DEPTH OF 6". ALL DEBRIS EXPOSED FROM EXCAVATION AND CULTIVATION SHALL BE DISPOSED OF AT THE CONTRACTOR'S EXPENSE.
- PLANTING
 - A. POSITION TREES AND SHRUBS AT THEIR INTENDED LOCATIONS AS PER THE PLANS AND SECURE THE APPROVAL OF THE LANDSCAPE ARCHITECT BEFORE EXCAVATING PITS, MAKING NECESSARY ADJUSTMENTS AS DIRECTED.
 - B. PLANTING PITS SHALL BE DUG WITH LEVEL BOTTOMS, AS SHOWN ON THE PLANTING DETAILS.
 - 3 PARTS TOPSOIL
 - 1 PART PEAT MOSS OR COMPOST
 - 1/3 PART MILORGANITE FERTILIZER
 - C. PREPARED SOIL SHALL BE TAMPED FIRMLY AT BOTTOM OF PIT. PREPARED SOIL AROUND BALL OF PLANT 1/2 WAY, AND WATER, COMPLETE BACK-FILLING AND WATER THOROUGHLY.
 - D. ALL PLANTS SHALL BE SET SO THAT, WHEN SETTLED, THEY BEAR THE SAME RELATION TO THE REQUIRED GRADE AS THEY BORE TO THE NATURAL GRADE BEFORE BEING TRANSPANTED.
 - E. IMMEDIATELY AFTER PLANTING, STAKE ALL TREES WITH 3 CEDAR STAKES PER TREE.
 - F. PREPARE RAISED EARTH SAUCER AS WIDE AS PLANTING HOLE OF EACH PLANT.
- FINISH GRADING
 - A. PLUSMINUS, 1 FOOT OF FINISH GRADE.
 - B. ALL LAWN AND PLANTING AREAS SHALL BE GRADED TO A SMOOTH, EVEN UNIFORM PLANE WITH NO ABRUPT CHANGE OF SURFACE. SOIL AREAS ADJACENT TO THE BUILDING SHALL SLOPE AWAY FROM THE BUILDING.
- GUARANTEE
 - A. CONTRACTOR SHALL GUARANTEE ALL PLANTS FOR A PERIOD OF ONE (1) YEAR.
- CLEAN-UP
 - A. UPON THE COMPLETION OF ALL PLANTING WORK AND BEFORE FINAL ACCEPTANCE, THE CONTRACTOR SHALL REMOVE ALL MATERIAL, EQUIPMENT, AND DEBRIS RESULTING FROM THIS WORK. ALL ACCEPTABLE CONDITIONS AS APPROVED BY THE OWNERS AUTHORIZED REPRESENTATIVE.
- MAINTENANCE
 - A. MAINTENANCE PERIOD TO COMMENCE AFTER FINAL INSPECTION.
 - B. MAINTENANCE PERIOD FOR THIS CONTRACT SHALL BE 90 CALENDAR DAYS COMMENCING AFTER FINAL INSPECTION OF CONSTRUCTION. MAINTAIN TREES, SHRUBS AND OTHER PLANTS BY PRUNING, CULTIVATING AND WEEDING AS REQUIRED FOR HEALTHY GROWTH. RESTORE PLANTING SAUCERS, TIGHTEN AND REPAIR STAKE AND GUY SUPPORTS AND RESET TREES AND SHRUBS TO PROPER GRADES OR VERTICAL POSITION AS REQUIRED. SPRAY AS REQUIRED TO KEEP TREES AND SHRUBS FREE OF INSECTS AND DISEASE. MAINTAIN LAWNS BY WATERING, FERTILIZING, WEEDING, MOWING, TRIMMING, AND OTHER OPERATIONS SUCH AS ROLLING, RESGRADING AND REPLANTING AS REQUIRED TO ESTABLISH A SMOOTH, ACCEPTABLE LAWN, FREE OF ERODED OR BARE AREAS.

KEY	QTY.	BOTANICAL NAME	COMMON NAME	MINIMUM SIZE	ROOT
<i>Trees</i>					
AB	13	Abies concolor	White Fir	5-6' Ht.	B&B
AC	2	Amelanchier canadensis	Serviceberry	1.5" Caliper	B&B
AR	3	Acer rubrum "October Glory"	October Glory Red Maple	2.5" Caliper	B&B
CK	2	Cornus kousa	Kousa Dogwood	1.5" Caliper	B&B
CO	7	Celtis occidentalis	Hackberry	2.5" Caliper	B&B
GT	11	Gleditsia tricanthos incrimis "Skycolor"	Skyline Thornless Honeylocust	2.5" Caliper	B&B
MS	4	Malus "Spring Snow"	Spring Snow Crabapple	1.5" Caliper	B&B
PG	6	Picea glauca	White Spruce	5-6' Ht.	B&B
PN	6	Pinus nigra	Austrian Pine	5-6' Ht.	B&B
ZS	8	Zelkova serrata	Japanese Zelkova	2.5" Caliper	B&B
<i>Shrubs</i>					
BG	24	Buxus "Green Velvet"	Green Velvet Boxwood	24" Ht.	#5 Cont.
CR	3	Cornus racemosa "Mus'am"	Muskingum Gray Dogwood	24" Ht.	#5 Cont.
HH	28	Hydrangea macrophylla "Jane"	Little Lime Hydrangea	24" Ht.	#5 Cont.
JO	8	Juniperus chinensis "Old Gold"	Old Gold Juniper	24" Ht.	#5 Cont.
PH	7	Pennisetum alopecuroides "Hameln"	Hameln Fountain Grass	24" Ht.	#5 Cont.
SB	36	Spiraea bumalda "Gold Flame"	Gold Flame Spirea	24" Ht.	#5 Cont.
WG	6	Weigela florida "Alexandra"	Wine & Roses Weigela	24" Ht.	#5 Cont.

KEY	QTY	BOTANICAL NAME	COMMON NAME	MINIMUM SIZE	SPACING
AI	761	Asclepias incarnata	Swamp Milkweed	2" Plug	12" O.C.
AN	765	Aster rosae-anthoe	New Zealand Aster	2" Plug	12" O.C.
BN	13	Betula nira "Culm"	Heritage River Birch	12 Ht. multi-stem form	As shown
IR	784	Iris versicolor	Blue Flag Iris	2" Plug	12" O.C.
IV	275	Ilex verticillata	Winterberry	2" Plug	24" O.C.
JE	731	Juncus effusus	Soft Rush	2" Plug	12" O.C.

A1 LANDSCAPING PLAN - SOUTH

SCALE: 1"=20'

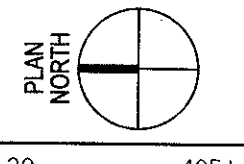

LANDSCAPING PLAN SOUTH

CL101