

LANDSCAPE NOTES

- THE CONTRACTOR SHALL PROVIDE MAINTENANCE INCLUDING FERTILIZING, RE-SEEDING, AND WATERING AS REQUIRED DURING LANDSCAPE INSTALLATION AND PLANTING FOR A MINIMUM PERIOD OF 12 MONTHS FROM PLANTING DATE.
- THE CONTRACTOR SHALL FURNISH AND INSTALL A 3" MINIMUM LAYER OF HIGH-QUALITY SHREDED HARDWOOD BARK OR CEDAR MULCH IN ALL PLANTING BEDS.
- ALL PROPOSED LANDSCAPE AREAS AND PLANTING BEDS SHALL BE EXCAVATED OF ALL BUILDING MATERIALS AND POOR UNSUITABLE SOILS TO A DEPTH OF 24" AND BACKFILLED WITH TOPSOIL AND THE PLANTING MIXTURE AS SPECIFIED IN THE DETAILS.
- THE CONTRACTOR SHALL ERECT TEMPORARY CONSTRUCTION FENCING AROUND ALL EXISTING TREES TO REMAIN WITHIN THE PROJECT LIMITS TO PROTECT FROM SITE WORK DISTURBANCE.
- UNLESS RECOMMENDED OTHERWISE BY THE SEED VENDOR OR THE LANDSCAPE CONTRACTOR, PERMANENT GRASS SEEDING SHALL CONSIST OF A MIXTURE OF THE FOLLOWING:
 - KENTUCKY BLUEGRASS = 25% BY WEIGHT (98% MIN. PURITY; 85% MIN. GERMINATION)
 - PENN LAWN RED FESCUE = 25% BY WEIGHT (95% MIN. PURITY; 80% MIN. GERMINATION)
 - TRIPLE CROWN PERENNIAL RYE = 50% BY WEIGHT (95% MIN. PURITY; 90% MIN. GERMINATION)
- HAND-BROADCASTING OR HYDRO-SEEDING AND HYDRO-MULCHING SHALL BE USED TO ESTABLISH ALL NEW LAWN AREAS. IF HAND-BROADCASTING, SEW SEED AT A RATE OF 5 lbs. PER 1000 SQ. FT. RAKE SEED INTO TOP 1/8" OF TOPSOIL, ROLL AND WATER WITH FINE MIST. WATER SEED AS RECOMMENDED BY SEED VENDOR. UNIFORMLY SPREAD 2 INCHES OF STRAW MULCH OVER ENTIRE SEEDED AREA AT THE RATE OF 2 TONS PER ACRE (90 lbs. / 1,000 SQ. FT.) IMMEDIATELY AFTER ROLLING AND WATERING SEEDED AREAS. THE STRAW MULCH SHALL BE ANCHORED WITH WOOD FIBER MULCH AT 750 lbs PER ACRE (17 lbs. / 1,000 SQ. FT.). THE WOOD FIBER MULCH SHALL BE APPLIED THROUGH A HYDRO-SEEDER IMMEDIATELY AFTER STRAW MULCH IS INSTALLED. REMOVE ANY WIND-SWEPT MULCH PILES AS NECESSARY TO PREVENT DAMAGE TO GRASS. HAY MULCH SHALL NOT BE USED.
- IN AREAS WHERE DECORATIVE STONES OR MULCH BEDS MAY BE USED, THE CONTRACTOR SHALL INSTALL A QUALITY WOVEN LANDSCAPE FABRIC (SUCH AS FABRISCAPE 4.75 OZ. WOVEN WEED RESTRICTOR PLUS OR APPROVED EQUAL) FOR WEED CONTROL BENEATH A 2"-3" LAYER OF #2 LANDSCAPE STONE OR CEDAR / HARDWOOD BARK MULCH. CALL (800) 992-0550 TO ORDER AND FOR INSTALLATION INSTRUCTIONS. ALTERNATE: THE CONTRACTOR SHALL APPLY PREEN WEED CONTROL PER MANUFACTURER'S APPLICATION INSTRUCTIONS IN PLACE OF LANDSCAPE FABRIC.
- TOPSOILING AND SEEDING, HYDROSEEDING, OR SODDING SHALL TAKE PLACE WITHIN 24 HOURS OF FINAL GRADING. SEED SHALL NOT BE BROADCAST DURING CONDITIONS OF HIGH WIND OR EXCESSIVE MOISTURE.
- ALL NEW LAWN AREAS SHALL HAVE A 6 INCH MINIMUM LAYER OF TOPSOIL BEFORE SEEDING.
- ANY EXISTING TREES TO REMAIN THAT ARE KILLED DUE TO ROOT DISTURBANCE SHALL BE REPLACED IN KIND BY THE CONTRACTOR.
- ALL NEW LAWN AREAS SHALL BE COMPLETE IN COVERAGE AND VIGOROUS IN GROWTH IN ORDER TO BE ACCEPTABLE. REPAIR, RE-SEED, AND WATER NEW LAWN AREAS AS NECESSARY UNTIL THEY REACH THE LEVEL OF FINAL ACCEPTANCE.
- REMOVE ALL STICKS, RUBBISH, STONES, AND ANY DEBRIS COLLECTED DURING RAKING, MOWING, AND LAWN ESTABLISHMENT ACTIVITIES. DISPOSE OF AT AN APPROPRIATE OFF-SITE LOCATION PER LOCAL REGULATIONS.
- SEEDING SHOULD BE DONE AFTER AUGUST 15 AND BEFORE MAY 15. THE DESIGN ENGINEER SHALL NOT BE RESPONSIBLE FOR SEED SURVIVAL OR GRASS ESTABLISHMENT IF SEEDING OCCURS OUTSIDE OF THIS TIME FRAME.
- ALL TOPSOIL (RE-USED ONSITE, BROUGHT IN FROM OFFSITE, OR MANUFACTURED) SHALL HAVE AT LEAST 6% BY WEIGHT OF FINE-TEXTURED STABLE ORGANIC MATERIAL, AND NO MORE THAN 20% MUCK SOIL SHALL NOT BE CONSIDERED TOPSOIL. ALL TOPSOIL SHALL NOT HAVE LESS THAN 20% FINE-TEXTURED MATERIAL PASSING THE NUMBER 200 SIEVE, AND NOT MORE THAN 15% CLAY. TOPSOIL MANUFACTURED OR BROUGHT IN FROM OFFSITE THAT IS PRE-TREATED WITH SOIL STERILANTS OR HERBICIDES SHALL BE SO IDENTIFIED TO THE PURCHASER AND LANDSCAPE CONTRACTOR. ALL TOPSOIL SHALL BE FREE OF STONES OVER 1-1/2 INCHES IN DIAMETER, TRASH, NOXIOUS WEEDS, NUT SEDGE, OR QUACKGRASS, AND SHALL CONTAIN NO MORE THAN 10% GRAVEL. TOPSOIL CONTAINING SOLUBLE SALTS GREATER THAN 500 PPM (PARTS PER MILLION) SHALL NOT BE USED. MANUFACTURED TOPSOIL SHALL CONSIST OF A MIXTURE OF ORGANIC MATERIAL SUCH AS COMPOST AND MINERAL MATERIAL COMPLYING WITH THE ABOVE SPECIFICATIONS.
- ALL TOPSOIL SHALL BE DISTRIBUTED TO A UNIFORM DEPTH AND NOT PLACED WHILE PARTIALLY FROZEN, MUDDY, OR ON FROZEN SLOPES OVER ICE, SNOW, AND STANDING WATER PUDDLES. TOPSOIL PLACED ON SLOPES GREATER THAN 5% (20:1) SHALL BE PROMPTLY FERTILIZED, SEEDED, MULCHED, AND STABILIZED BY TRACKING WITH SUITABLE EQUIPMENT PER THE SPECIFICATIONS ABOVE.

HYDRO-SEED & HYDRO-MULCH INSTALLATION INSTRUCTIONS:

- *** AREAS TO BE HYDRO-SEEDED AND HYDRO-MULCHED WITH HYDROSTRAW ARE SHOWN ON THE EROSION CONTROL PLAN. THE CONTRACTOR SHALL CONTACT HYDROSTRAW (800) 545-1755 TO ORDER, AND FOR A LIST OF CERTIFIED HYDROMULCH APPLICATOR CONTRACTORS.
- TILL AREAS OF INSTALLATION TO A 4 INCH MINIMUM DEPTH. THEN TOPSOIL AREAS OF INSTALLATION TO STABILIZED FINISHED GRADE. ADD LIME AND FERTILIZER TO SOIL (IF REQUIRED) AT 400 lbs PER ACRE 24 HOURS BEFORE TILLING. REMOVE ALL ROCKS, CLODS, VEGETATION, OR OTHER OBSTRUCTIONS SO THAT THE SEED WILL HAVE DIRECT CONTACT WITH THE SOIL SURFACE.
 - HYDRO-SEED GRASS AS PER SEED VENDOR'S INSTRUCTIONS.
 - APPLY HYDRO-MULCH TO COVER THE GRASS SEED PER HYDROMULCH SPECIFICATIONS IMMEDIATELY FOLLOWING SEEDING. APPLY AT 2,000 lbs PER ACRE MINIMUM FOR SLOPES 3:1 AND FLATTER. APPLY HYDROSTRAW GUAR PLUS AT 3,000 lbs PER ACRE MINIMUM FOR SLOPES BETWEEN 2:1 AND 3:1. APPLY HYDROSTRAW BONDED FIBER MATRIX AT 4,500 lbs PER ACRE MINIMUM FOR SLOPES BETWEEN 1:1 AND 2:1.
 - HYDROMULCH SHOULD BE APPLIED AT LEAST 8 HOURS PRIOR TO RAINSTORM EVENTS.

HYDRO-SEED & HYDRO-MULCH MAINTENANCE INSTRUCTIONS:

- THE SLOPE SHALL BE MONITORED DAILY FOR EROSION ESPECIALLY AFTER RAIN STORMS. RE-APPLICATION SHALL BE REQUIRED WHEREVER ACCEPTABLE GERMINATION IS NOT OBTAINED.
- KEEP HYDRO-SEEDED AND HYDRO-MULCHED AREAS MOIST BY DAILY APPLICATION OF WATER FOR A MINIMUM OF TEN DAYS UNTIL THE SEEDS HAVE GERMINATED, OR AS RECOMMENDED BY THE SEED VENDOR.
- THE ABOVE SHALL BE THE RESPONSIBILITY OF THE CONTRACTOR.
- THE GRASS SHOULD NOT BE MOWED UNTIL IT REACHES AT LEAST 3/4 INCHES IN HEIGHT. MOW ONLY THE TOP THIRD OF EACH GRASS BLADE TO ENSURE SURVIVAL.

HYDROMULCH INSTALLATION

SCALE: N.T.S.

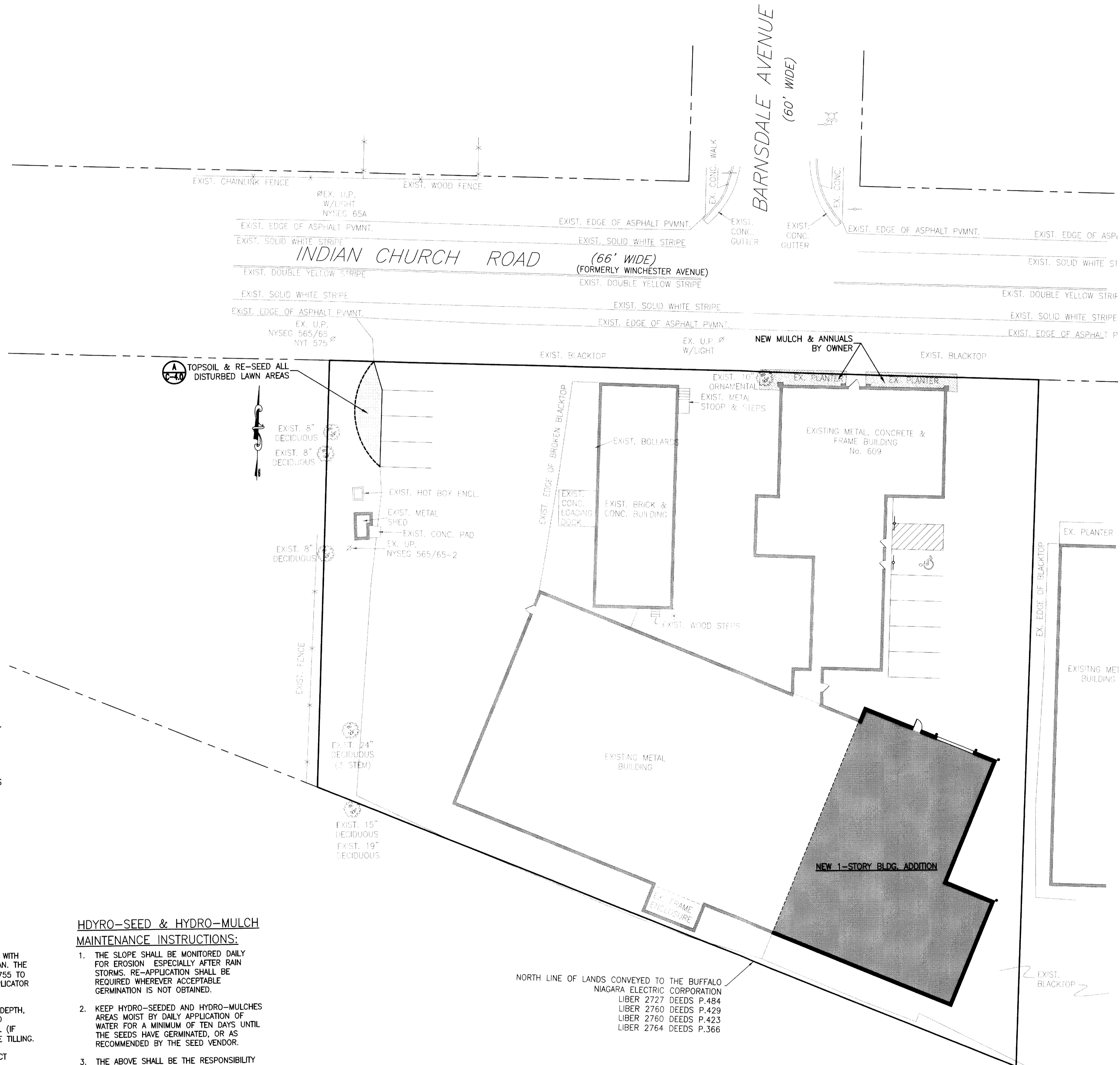
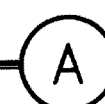

SITE LANDSCAPE PLAN
SCALE: 1" = 20'-0"

LEGEND

- (Symbol) EXISTING TREE OR SHRUB TO REMAIN
- (Symbol) EXISTING SIGN
- (Symbol) NEW SIGN
- (Symbol) EXISTING UTILITY POLE
- (Symbol) EXISTING FENCE
- (Symbol) EXISTING EDGE OF PAVEMENT
- (Symbol) NEW EDGE OF PAVEMENT
- (Symbol) EXISTING CURB
- (Symbol) NEW CURB
- (Symbol) SITE PROPERTY LINE
- (Symbol) ADJACENT PROPERTY LINE
- (Symbol) NEW MULCH AREAS
- (Symbol) NEW LAWN AREAS

THE CONTRACTOR SHALL CONTACT THE DESIGN ENGINEER BEFORE EXCAVATION & CONSTRUCTION TO ENSURE HE/SHE HAS THE FINAL SET OF DESIGN DOCUMENTS AS ISSUED FOR CONSTRUCTION. THIS PLAN IS CURRENT AS OF THE DATE IT WAS ISSUED. SUBSEQUENT UPDATES OF THIS PLAN BY THE DESIGN ENGINEER DOES NOT AFFORD ANY TRANSFER OF THE RIGHT TO REUSE SAID UPDATES, BUT PLACES THE RESPONSIBILITY TO THE TRANSFEREE TO OBTAIN UPDATED PLANS WHICH ARE ISSUED FOR CONSTRUCTION AS THESE MAY DIFFER FROM PREVIOUS PLANS ISSUED FOR PERMIT OR BID.

ARCHITECTURAL BUILDING PRODUCTS ADDITION
609 INDIAN CHURCH ROAD
WEST SENECA, NEW YORK 14224



| | |
|----------------------|---------|
| ISSUED FOR SEQR REV. | 6/21/18 |
|----------------------|---------|

SITE LANDSCAPE PLAN

studio T3
CONCEPTS, INC.
2495 Main Street, Suite 301
Buffalo, New York 14214
Phone: (716) 803-6400
Fax: (716) 810-9564

DRAWN BY: AVT
CHECKED BY: OST
JOB # 18-038A

SHEET
C-4.0

WARNING: IT IS A VIOLATION OF SECTION 2209, SUBDIVISION 2, OF THE NEW YORK STATE EDUCATION LAW FOR ANY PERSON, UNLESS ACTING UNDER THE DIRECTION OF A LICENSED ARCHITECT OR PROFESSIONAL ENGINEER, TO ALTER IN ANY WAY, PLANS, SPECIFICATIONS, OR REPORTS TO WHICH THE SEAL OF A LICENSED ARCHITECT OR PROFESSIONAL ENGINEER HAS BEEN APPLIED.